

EAST SIDE TRAIL

Worcester, Mass.

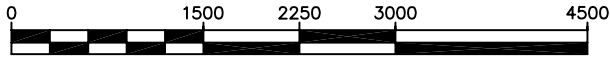

1 inch = 1500 ft.
(REVISED 01/07/08)

THIS MAP WAS PREPARED FROM SCALED DATA INPUT BASED UPON AVAILABLE RECORD PLANS. TRAIL ROUTES AND VARIOUS FEATURES SHOWN HEREON ARE APPROXIMATE ONLY.

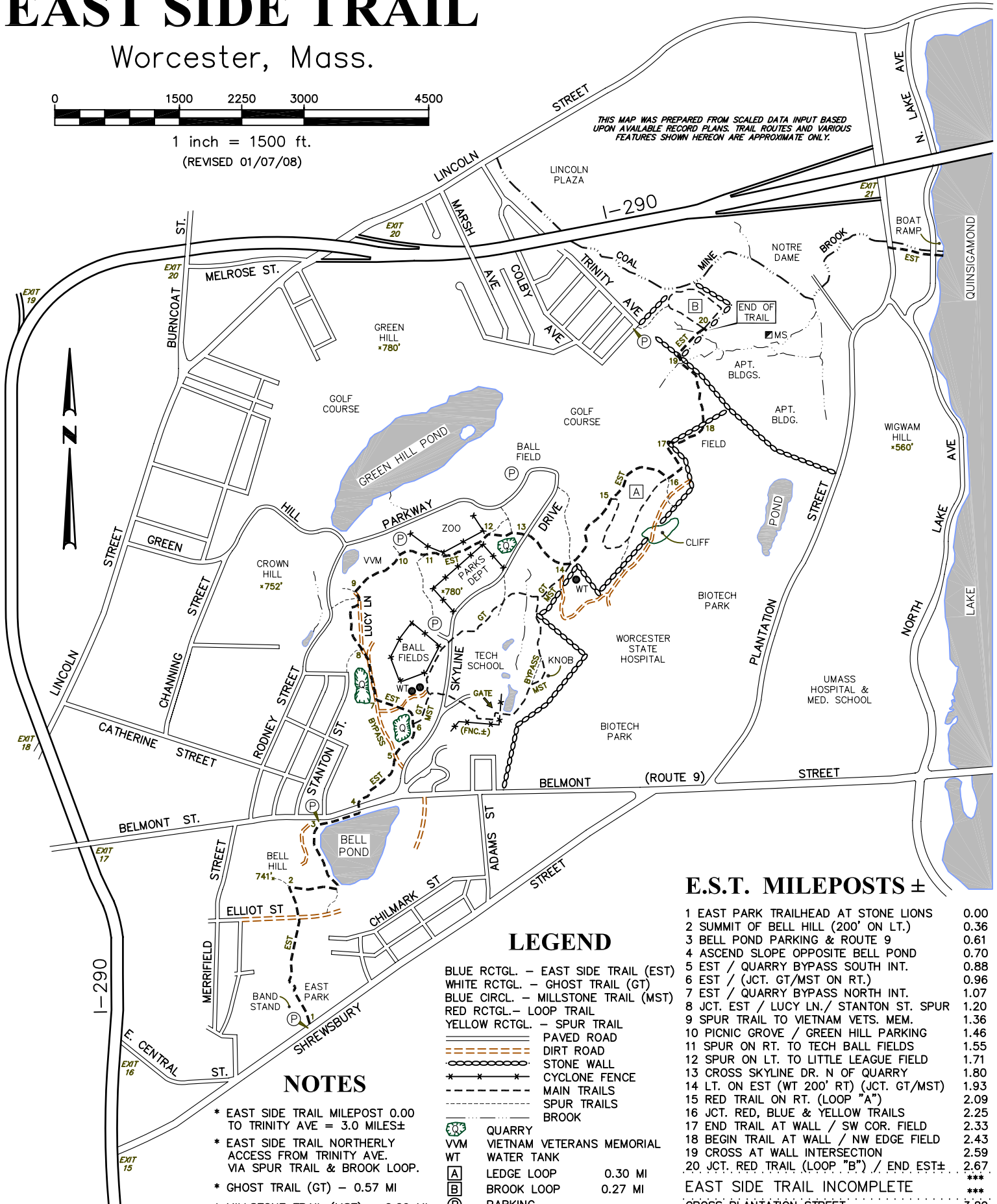

E.S.T. MILEPOSTS ±

1 EAST PARK TRAILHEAD AT STONE LIONS	0.00
2 SUMMIT OF BELL HILL (200' ON LT.)	0.36
3 BELL POND PARKING & ROUTE 9	0.61
4 ASCEND SLOPE OPPOSITE BELL POND	0.70
5 EST / QUARRY BYPASS SOUTH INT.	0.88
6 EST / (JCT. GT/MST ON RT.)	0.96
7 EST / QUARRY BYPASS NORTH INT.	1.07
8 JCT. EST / LUCY LN. / STANTON ST. SPUR	1.20
9 SPUR TRAIL TO VIETNAM VETS. MEM.	1.36
10 PICNIC GROVE / GREEN HILL PARKING	1.46
11 SPUR ON RT. TO TECH BALL FIELDS	1.55
12 SPUR ON LT. TO LITTLE LEAGUE FIELD	1.71
13 CROSS SKYLINE DR. N OF QUARRY	1.80
14 LT. ON EST (WT 200' RT) (JCT. GT/MST)	1.93
15 RED TRAIL ON RT. (LOOP "A")	2.09
16 JCT. RED, BLUE & YELLOW TRAILS	2.25
17 END TRAIL AT WALL / SW COR. FIELD	2.33
18 BEGIN TRAIL AT WALL / NW EDGE FIELD	2.43
19 CROSS AT WALL INTERSECTION	2.59
20 JCT. RED TRAIL (LOOP "B") / END EST±	2.67
EAST SIDE TRAIL INCOMPLETE	***
CROSS PLANTATION STREET	3.29
LAKE QUINSIGAMOND	3.43

LEGEND

BLUE RCTGL.	- EAST SIDE TRAIL (EST)
WHITE RCTGL.	- GHOST TRAIL (GT)
BLUE CIRC.	- MILLSTONE TRAIL (MST)
RED RCTGL.	- LOOP TRAIL
YELLOW RCTGL.	- SPUR TRAIL
—	- PAVED ROAD
- - -	- DIRT ROAD
— · — · —	- STONE WALL
* * *	- CYCLONE FENCE
- - -	- MAIN TRAILS
- - -	- SPUR TRAILS
- - -	- BROOK
⊞	- QUARRY
VVM	- VIETNAM VETERANS MEMORIAL
WT	- WATER TANK
A	- LEDGE LOOP 0.30 MI
B	- BROOK LOOP 0.27 MI
P	- PARKING
MS	- MINE SHAFT

NOTES

- * EAST SIDE TRAIL MILEPOST 0.00 TO TRINITY AVE = 3.0 MILES±
- * EAST SIDE TRAIL NORTHERLY ACCESS FROM TRINITY AVE. VIA SPUR TRAIL & BROOK LOOP.
- * GHOST TRAIL (GT) - 0.57 MI
- * MILLSTONE TRAIL (MST) - 0.69 MI (MST NOT BLAZED SOUTH OF TECH SCHOOL EAST TO FENCE AT POND).